

# DTR-LI Serisi 1-3 kVA

1/1 Online UPS



YÜKSEK VERİM



TEMİZ ENERJİ



DOĞA DOSTU  
TEKNOLOJİ



TÜM CİHAZLARA  
UYUMLU



Li  
Lithium

LITHIUM BATTERY



ON-LINE VERİM

>94%

ON-LINE EFFICIENCY



USB / RS232

USB  
UNIVERSAL SERIAL BUS

USB / RS232

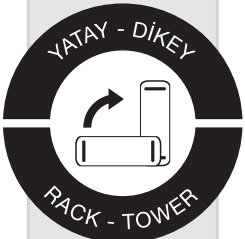

YATAY - DİKEY

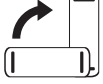

RACK - TOWER



ÇIKIŞ GÜÇ FAKTÖRÜ

0.8

OUTPUT POWER FACTOR



*DTR-LI Series Online Double Conversion UPS has DSP microprocessor unit and thanks to DSP it handles most critical duties for home, office, laboratory appliances and provides enhanced power protection.*

### Lithium Battery Advantages

- 3 Times more charge-discharge count \**
- 20min supply time at full load with built-in lithium battery pack \**
- 6 Times longer backup time \**
- 2 Times longer life expectancy \**
- 60% Lighter \**
- Takes up 50% less space \**

*DTR-LI Serisi Online Çift Çevrim UPS, DSP mikroişlemci ünitesi sayesinde ev, ofis, laboratuvar için en önemli kritik görevlerin üstesinden gelir ve gelişmiş güç koruması sağlar.*

### Lithium Batarya Avantajları

- \* 3 Kat daha fazla şarj-deşarj sayısı*
- \* Dahili lithium akü grubu ile tam yükte 20 dk bekleme süresi*
- \* 6 Kat daha uzun yedekleme süresi*
- \* 2 Kat daha uzun ömür beklentisi*
- \* %60 Daha hafif*
- \* %50 Daha az yer kaplar*

Technical Specifications	DTR-1LI	DTR-2LI	DTR-3LI
Rated Power / Output Active Power	1 kVA / 800W	2 kVA / 1600W	3 kVA / 2400W
<b>INPUT</b>			
Input Formats	L+N+PE		
Rated Input Voltage	208/220/230/240VAC		
Voltage Range	110~300VAC, 110~176VAC, 280~300VAC (Power Limited)		
Frequency Range	50/60 ± 6Hz (Default) ± 10Hz (Setable)		
Input Power Factor	≥0.99		
Input Harmonic Distortion	≤3% THD (Linear Load), ≤5% THD (Non-Linear Load) (PF=0.8)		
<b>OUTPUT</b>			
Output Formats	L+N+PE		
Output Voltage	208/220/230/240VAC		
Output Accuracy	±1%		
Output Frequency	AC Mode: Same as AC, Battery Mode: 50/60 Hz±1%		
Output Harmonic Distortion	≤ 3% THD (Linear Load), ≤ 5% THD (Non-Linear Load) PF=0.8		
Output Power Factor	0.8		
Transform Time	AC Mode to Battery Mode: 0ms, Inverter Mode to Bypass Mode 4ms		
Over Load Capacity	AC Mode: 30min@102%~110% Load; 10min@110%~130% Load; 30s@130%~150% Load; 200ms@>150% Load Battery Mode: 1min@102%~110% Load; 10s@110%~130% Load; 3s@130%~150% Load; 200ms@>150% Load		
<b>MACHINE EFFICIENCY</b>			
AC Mode (Full Load Efficiency)	Full Load Efficiency 94.5%@220VDC	Full Load Efficiency 95.5%@220VDC	
Battery Mode (Full Load Efficiency)	Full Load Efficiency 89.5%@36VDC	Full Load Efficiency 91.5%@72VDC	
<b>BATTERY</b>			
Battery Lifecycle	>2000		
Single Cell Type	LFP26700-3600mA		
Battery Cell Configuration	12x3.2V/7.2Ah	24x3.2V/7.2Ah	24x3.2V/10.8Ah
Battery Voltage	38.4V	76.8V	76.8V
Autonomy Time	20 Min		
Charging Voltage	42VDC ± 1%	84VDC ± 1%	84VDC ± 1%
Charging Mode	2 State Charging Management (CC-CV)		
Charging Current	4A Default, 12A (Max)		4A Default, 4A (Max)
<b>WORKING ENVIRONMENT</b>			
Ambient Temperature	0~40°C		
Ambient Humidity	20%~95% (No Condensation)		
Storage Temperature	-15~60°C (Battery: 0~40°C)		
Altitude	<1000m, Derating at Above 1000m, Maximum 4000m, Refer to IEC62040		
LCD	Working Mode / Load / Battery Power / Input / Output ECT		
Case Size (WxHxD) [mm]	438x88 (2U)x413	438x88 (2U)x532	438x88 (2U)x532
Weight [kg]	10.75	14.35	18.35
<b>STANDARDS</b>			
Standard & Certification	EN / IEC 61000, EN / IEC 62040, GB / T 4943, YD / T 1095, TLC ets.		
<b>COMMUNICATION INTERFACE</b>			
Interface	1*USB, 1*RS232, 1*EPO		

\* Derate capacity to %80 when the output voltage is adjusted to 208VAC